

CLEAN AIR E™

FUME EXTRACTION MIG GUN

MIG (GMAW)
AND FLUX CORED (FCAW) WELDING



Issued April 2026 | Index No. CLE/1.3

APPLICATIONS	• Heavy Equipment • General Manufacturing & Fabrication • Commercial Truck & Trailer
PROCESSES	• MIG (GMAW) • Flux Cored (FCAW)
RATED OUTPUT	• 300A • 400A
DUTY CYCLE	• 60% with Mixed Gases
CABLE LENGTH	• 15' • 20' • 25'
WIRE SIZE	• 0.030"- 5/64" (0.8 mm-2.0 mm)

Bernard Clean Air E fume extraction MIG guns capture up to 95% of welding fumes at the source, helping users maintain compliance and a cleaner welding environment. Built with a robust, ergonomic design, these guns support extended use while minimizing operator fatigue and reducing downtime.

Clean Air E MIG guns utilize AccuLock™ consumables for reliable wire feeding and fewer consumable changes—ultimately driving down maintenance costs. The result is a versatile fume extraction solution that meets the demands of heavy industrial applications, delivers consistent weld quality, and promotes higher productivity without compromising on comfort or performance.

- Comparable weight and handle size to standard air-cooled MIG guns
- Compatible with vacuum systems from most major manufacturers
- Removes fumes directly at the source for cleaner air and reduced visible fume
- Built for long-lasting performance in demanding environments
- Ease of maintenance



CONFIGURE YOUR MIG GUN ONLINE

BUILD YOUR FUME EXTRACTION GUN
TO MATCH YOUR APPLICATION



**IMPROVED FLEXIBILITY
REDUCED WRIST FATIGUE**
REDUCE WRIST AND HAND
FATIGUE WITH HOSE SWIVEL

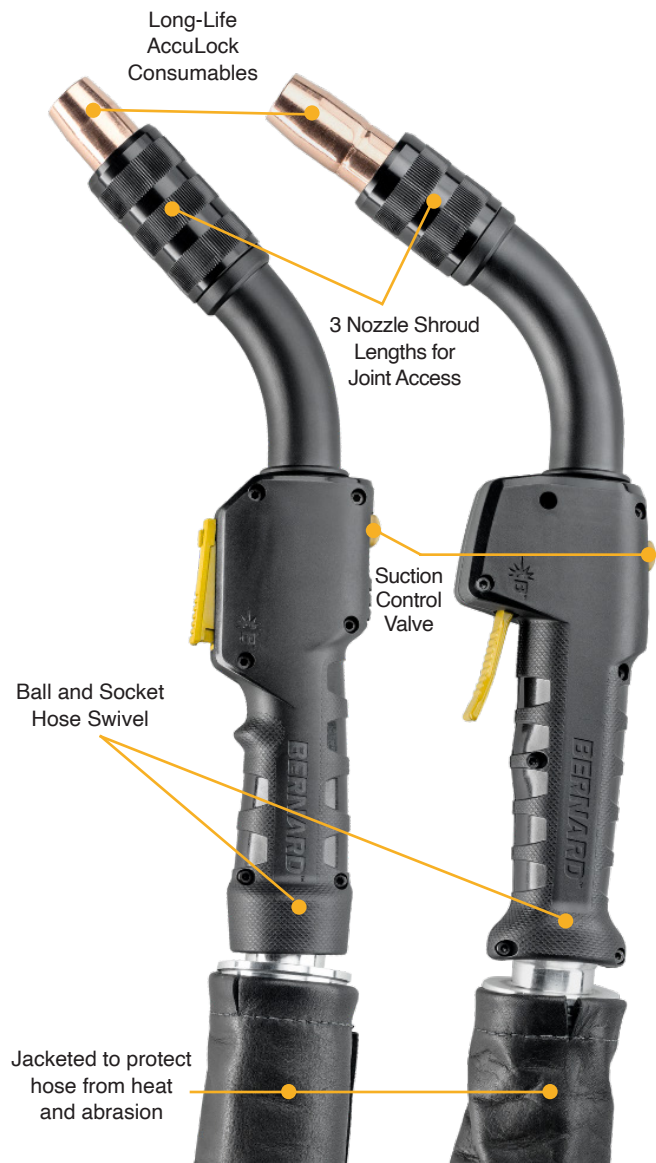

BERNARD™

449 West Corning Road
Beecher, Illinois 60401 USA

1-855-MIGWELD (644-9353)
(US & Canada Only)

For more information,
visit us at bernardtregaskiss.com

CONSUMABLES

[CONFIGURABLE OPTION ONLINE]

ACCULOCK™ S CONSUMABLE SERIES

Contact Tips

T-A030CH	0.030" (0.8 mm)
T-A035CH	0.035" (0.9 mm)
T-A045CH	0.045" (1.2 mm)
T-A052CH	0.052" (1.4 mm)
T-A062CH	1/16" (1.6 mm)
T-A072CH	0.072" (1.8 mm)
T-A078CH	5/64" (2.0 mm)

Aluminum-Specific Contact Tips

T-A035AL	0.035" (0.9 mm)
T-A047AL	3/64" (1.2 mm)
T-A062AL	1/16" (1.6 mm)

Nozzles — Large

N-A3400C	3/4" bore, flush, copper
N-A3418C	3/4" bore, 1/8" recess, copper
N-A3414C	3/4" bore, 1/4" recess, copper
N-A3418B	3/4" bore, 1/8" recess, brass
N-A3414B	3/4" bore, 1/4" recess, brass

Nozzles — Small

NS-A5800C	5/8" bore, flush, copper
NS-A5818C	5/8" bore, 1/8" recess, copper
NS-A5800B	5/8" bore, flush, brass
NS-A5818B	5/8" bore, 1/8" recess, brass
NS-A1200B	1/2" bore, flush, brass
NS-A1218B	1/2" bore, 1/8" recess, brass

Nozzles — Large

N-A5800C	5/8" bore, flush, copper
N-A5818C	5/8" bore, 1/8" recess, copper
N-A5814C	5/8" bore, 1/4" recess, copper
N-A5818B	5/8" bore, 1/8" recess, brass
N-A5814B	5/8" bore, 1/4" recess, brass

Nozzles — Small

NS-A1218C	1/2" bore, 1/8" recess, copper
NST-A3800B	3/8" bore, flush, brass
NST-A3818B	3/8" bore, 1/8" recess, brass
NST-A38XTB	3/8" bore, 1/8" ext., brass
NST-A1218B	1/2" bore, 1/8" recess, brass

Diffusers For use with Front Load Liners

D-A1	Large, brass, thread-on	DS-A1	Small, brass, thread-on
D-A2	Large, brass, slip-on	DS-A2	Small, brass, slip-on

Diffusers For use with Rear Load Liners

D-A1-C	Large, brass, thread-on	DS-A1-C	Small, brass, thread-on
D-A2-C	Large, brass, slip-on	DS-A2-C	Small, brass, slip-on

LINERS

[CONFIGURABLE OPTION ONLINE]



FRONT LOAD LINERS

SEE ACCULOCK S CONSUMABLES SPEC SHEET ([SP-ALS](#)) FOR PART NUMBERS AND MORE INFORMATION AND ADDITIONAL OPTIONS THAT CAN BE ORDERED SEPARATELY.

REAR LOAD LINERS

15' (4.57 m) Gun Lengths

L2A-15	for 0.030" - 0.035" wire	LD4A-15*	for 0.045" - 1/16" wire
LD3A-15*	for 0.035" - 0.045" wire	L6A-15	for 5/64" wire

25' (7.62 m) Gun Lengths

L2A-25	for 0.030" - 0.035" wire	LD4A-25*	for 0.045" - 1/16" wire
LD3A-25*	for 0.035" - 0.045" wire	L6A-25	for 5/64" wire

*E-Z FEED LINER TECHNOLOGY



E-Z FEED™ REAR LOAD LINERS

E-Z Feed Rear Load liners feature a unique profile and protective coating that improves wire feedability through the MIG gun. Its design shields wire from moisture and humidity while reinforcing rigidity for better wire support. The E-Z Feed liner technology is especially effective for feeding hard-to-feed wires like metal-cored and stainless steel.

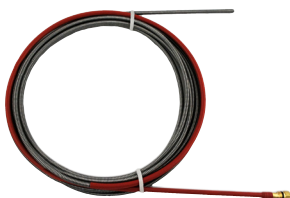

FRONT END PARTS

[CONFIGURABLE OPTION ONLINE]



NECKS

EN-345 45° Neck
EN-345L 45° Neck, Extended Length

EN-360 60° Neck
EN-360L 60° Neck, Extended Length



NECK TUBES

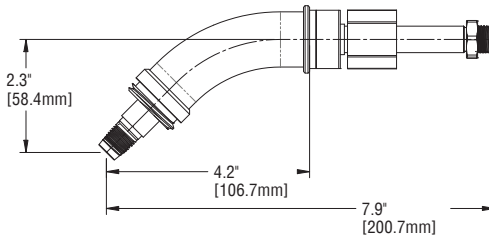

ENT-45 45° Neck Tube

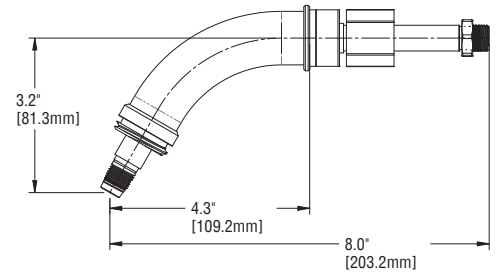

ENT-60 60° Neck Tube

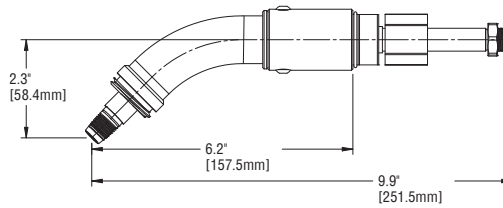

ENT-345L 45° Neck Tube, Extended Length

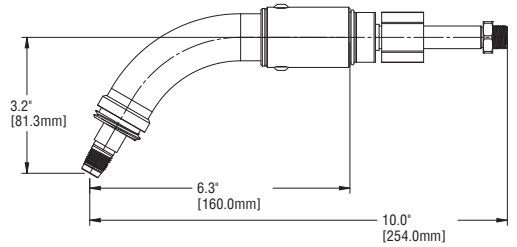

ENT-360L 60° Neck Tube, Extended Length

EXTRACTION SHROUDS

ES-L1S Extraction shroud, short length, small nozzle
ES-L2S Extraction shroud, medium length, small nozzle
ES-L3S Extraction shroud, long length, small nozzle

ES-L1 Extraction shroud, short length, large nozzle
ES-L2 Extraction shroud, medium length, large nozzle
ES-L3 Extraction shroud, long length, large nozzle



Shrouds with Straight Knurl



Shrouds with Diamond Knurl

POWER PINS

[CONFIGURABLE OPTION ONLINE]

POWER PINS SHOWN ARE FOR USE WITH REAR LOAD LINERS ONLY.

MILLER®

2520111	Strain Relief	214-116	Power Pin Tip for 0.023"-1/16"
2200137	Power Pin (Includes O-Rings)	214-332	Power Pin Tip for 5/64"-3/32"
414-400-20	Power Pin Insulator	GN2021	Trigger Control Plug

EURO™

2520069	Strain Relief
EPK-E	Euro Kit

LINCOLN®

2520111	Strain Relief	GLM1	Gas Line Assy.
214-2-1	Power Pin	SCL1N	Trigger Control Plug
414-400-14	Power Pin Insulator		

TWECO® #4

2520111	Strain Relief	GN2021	Trigger Cable Adaptor, Miller®	SCX1N	Trigger Control Plug, NAS Plug
214	Power Pin (Includes O-Rings)	SCT1N	Trigger Control Lead, Standard		
414-400-20	Power Pin Insulator	SCL1N*	Trigger Control Lead, Lincoln®		

SEE ACCULOCK S CONSUMABLES SPEC SHEET (SP-ALS) FOR POWER PIN PART NUMBERS AND INFORMATION WHEN USING FRONT LOAD LINERS.
 * DEFAULT TRIGGER CONTROL LEAD FOR TWECO #4 POWER PIN SELECTION

ACCESSORIES

JACKETS

EJK-6	Standard Length (6-foot) <i>(Installed on Build)</i>	EJK-20	Full Length (20-foot, velcro)
--------------	---	---------------	-------------------------------

Y CONNECTOR KIT

EYK-3 300 AMP



EYK-4 400 AMP



EYK-AS2 Adaptor Sleeve, 1-3/4" to 2" O.D. (4.4 cm - 5.1 cm)



Fits EYK-3 or EYK-4.

HOSE KIT

EHK-15	15-foot hose kit	EHK-20	20-foot hose kit	EHK-25	25-foot hose kit
---------------	------------------	---------------	------------------	---------------	------------------

HANDLE KIT

HANDLE KITS INCLUDE HARDWARE, ACTIVATION SWITCH AND HANDLE PARTS.

EHK-L Lever handle



EHK-B Button handle



ACCESSORIES CONTINUED

TRIGGERS

411-2-BZ Lever style, standard length

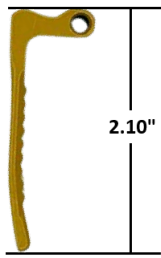

411-23-BZ Lever style, extended length

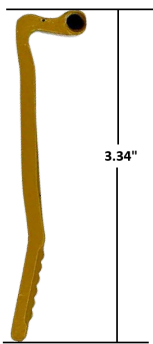

211-2-BZ

Button style, standard length

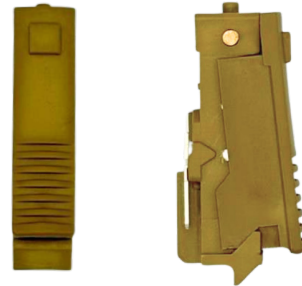

FUME CAPTURE OPTIMIZATION

Follow the diagram below for optimizing the efficiency of fume capture from your fume extraction MIG gun. The joints and positions of welds will affect the efficiency of fume capture.

Optimal capture efficiency is achieved when fume gun is positioned directly above the weld puddle.

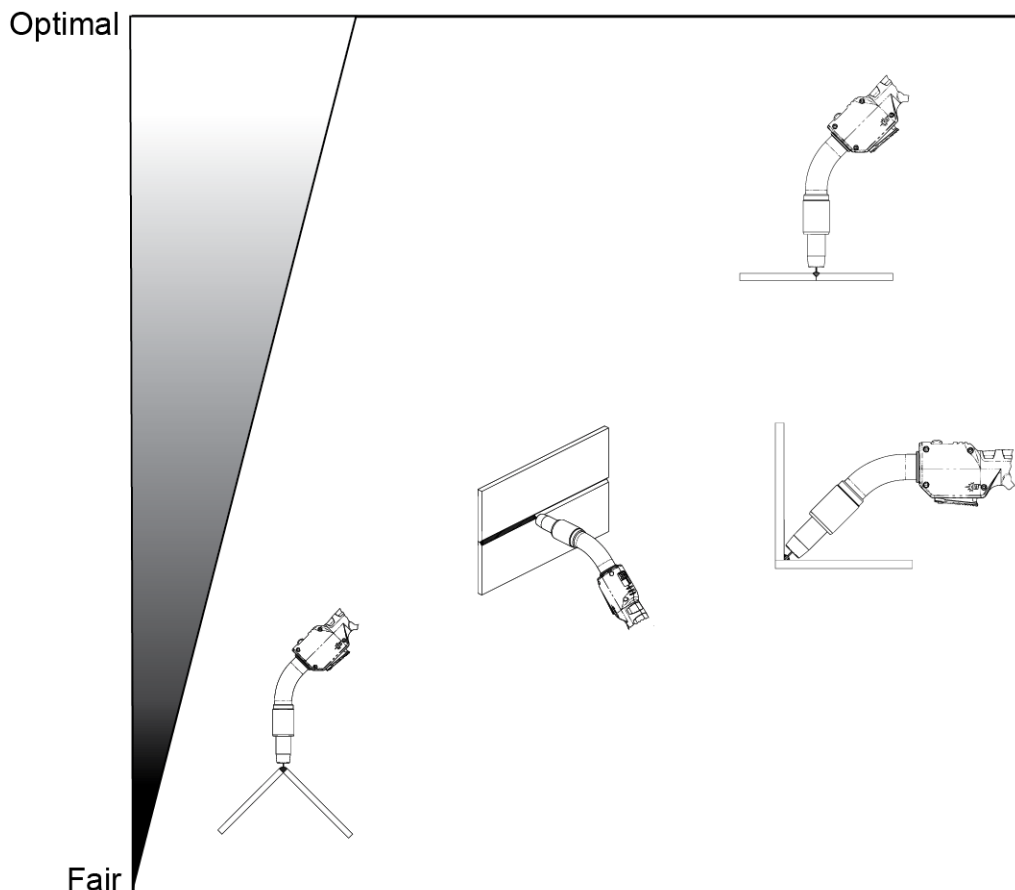
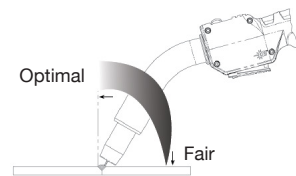

ORDERING INFORMATION

Amperage	Cable Length	Handle & Trigger	Neck	Consumables	Wire Size	Power Pin	Liner Type
E40	15	A	K	5	E	M	C
E30 300 amp Max. wire size 0.045"	15 15' (4.57 m)	A Lever Switch Trigger on Bottom	J Med. 45°	4 AccuLock S, Small, Rear Load [†]	B 0.030" (0.8 mm)	E Euro [^]	A Front Load Liner ^{†††}
E3J 300 amp, full length jacket Max. wire size 1/16"	20 20' (6.16 m)	B Lever Switch Trigger on Top	K Med. 60°	5 AccuLock S, Large, Rear Load [†]	C 0.035" (0.9 mm)	L Lincoln	C Rear Load Liner [†]
E40 400 amp Max. wire size 1/16"	25 25' (7.63 m)	C Lever Switch on Bottom, Ext Length	L Ext. Length 45°	6 AccuLock S, Small, Front Load ^{†††}	D 0.039" (1.0 mm)	M Miller	
E4J 400 amp, full length jacket Max. wire size 1/16"		D Lever Switch on Top, Ext Length	M Ext. Length 60°	7 AccuLock S, Large, Front Load ^{†††}	E 0.045" (1.2 mm)	T Tweco #4 (Lincoln lead)	
		F Button Switch Standard Trigger			H 0.052" (1.4 mm)		
					I 1/16" (1.6 mm)		
					R 3/64" (1.19 mm)		
					ALUMINUM		
					Q 0.035" (0.9 mm)		
					R 3/64" (1.2 mm)		
					S 1/16" (1.6 mm)		

BRAND AND PRODUCT NAMES SHOWN ABOVE ARE TRADEMARKS OF THEIR RESPECTIVE OWNERS.

[^] AVAILABLE WITH REAR LOAD LINER ONLY

^{†††} CONSUMABLES COMPATIBLE WITH FRONT LOAD LINERS

[†] CONSUMABLE COMPATIBLE WITH REAR LOAD LINERS

BERNARD®, ACCULOCK™, CENTERFIRE™, CLEAN AIR™ ARE TRADEMARKS OF BERNARD, A DIVISION OF MILLER ELECTRIC MFG. LLC
TREGASKISS® AND TOUGH LOCK™ ARE TRADEMARKS OF TREGASKISS, A DIVISION OF ITW CANADA INC.

SUBJECT TO CHANGE - THE INFORMATION PRESENTED IN THIS SPEC SHEET IS ACCURATE TO THE BEST OF OUR KNOWLEDGE AT THE TIME OF PRINTING.

PLEASE VISIT BERNARDTREGASKISS.COM FOR THE MOST UP-TO-DATE INFORMATION.

DISTRIBUTED BY:

©2025 Bernard®

