

| | |
|-------------------|---|
| PROCESSES | • MIG (GMAW) Welding |
| ROBOTS | • ABB® • FANUC® • Kawasaki® • KUKA® • Nachi® • OTC Daihen® • Panasonic® • Yaskawa® Motoman® |
| DUTY CYCLE | • 100%: 350 amp with Mixed Gases Ratings are based on tests that comply with IEC 60974-7 |

NEXT-LEVEL PRECISION, UPTIME, AND OVERALL EQUIPMENT EFFECTIVENESS

The Tregaskiss® ATLAS™ Robotic ThruArm MIG Welding Torch delivers next-level performance through rugged durability and precise, repeatable welds.

Its intuitive, modular design supports greater uptime by making maintenance faster and more consistent, while maintaining precise and repeatable Tool Center Point (TCP) in demanding environments.

- Engineered for demanding robotic welding applications with a focus on durability, precision, and ease of use.
- Delivers consistent TCP accuracy, even after maintenance, to ensure high-quality and repeatable welds.
- Simplifies maintenance and reduces training time, helping teams work more efficiently with fewer errors.
- Rugged construction protects key components from spatter, debris, and wear in tough industrial applications.
- Helps improve overall equipment effectiveness (OEE) by reducing rework, maintenance time, and production interruptions.
- Easy to service and operate, making it ideal for facilities facing labor shortages or high turnover.



EASY MAINTENANCE WITH MINIMAL DOWNTIME



NEW FEATURES PROVIDE INCREASED DURABILITY

SYSTEM COMPONENTS

SYSTEM COMPONENTS FOR ALL ROBOTS

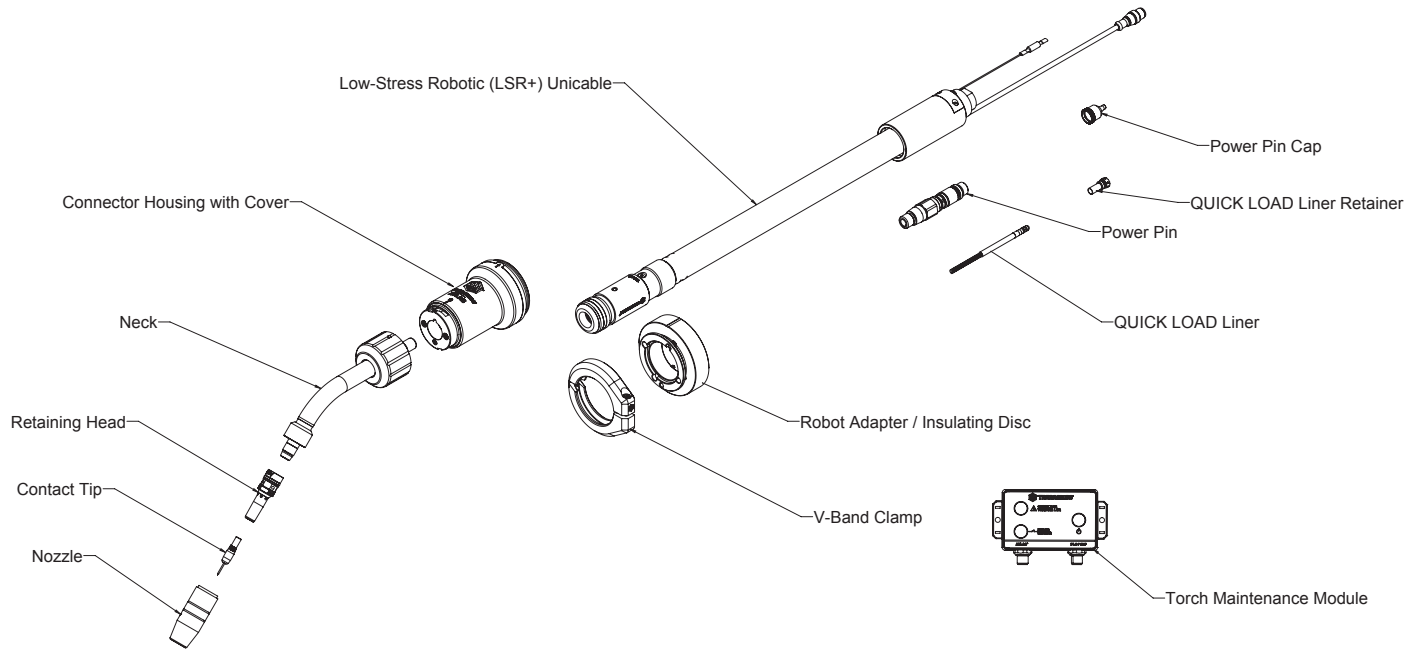

SPECIFICATIONS

THRUARM ROBOTIC ARTICULATION LIMITS FOR LSR+ UNICABLES

| Axis | Articulation Limit |
|------|--------------------|
| 5 | +/- 90° |
| 4+6 | +/- 270° |

NOTE: ANY ARTICULATION BEYOND THESE LIMITS IS CONSIDERED ABUSE OF THE CABLE AND WILL ACCELERATE LSR+ UNICABLE WEAR.

KNOW YOUR OPTIONS



ACCULOCK™ R CONSUMABLES

Eliminate contact tip cross-threading issues with AccuLock R consumables. These new consumables are designed for increased tip life, which can reduce replacement frequency and related downtime. AccuLock HDP contact tips can increase life by an additional 6-10x longer in pulse welding applications. And in most cases, your current tip and diffuser can be replaced with no impact to Tool Center Point (TCP), making this upgrade low effort, low risk, and high payoff.

AIR BLAST

Air blast utilizes compressed shop air to clear loose debris from front-end consumables thereby reducing the frequency of nozzle cleaning. 80 – 100 psi maximum air supply required for proper operation. This option is available for all Atlas™ robotic air-cooled MIG torches. **Ordered Separately*



QUICK LOAD® E-Z FEED™ LINERS

The QUICK LOAD E-Z FEED liner system loads from the front of the MIG torch, and requires less than half the time and effort for replacement when compared with rear load liners. These liners interface with a QUICK LOAD liner retainer that is seated within the power pin of the torch on first use. QUICK LOAD liners come standard on Tregaskiss robotic MIG torches unless wire brake is a selected option. Available for wire sizes between 0.035" and 1/16" and in lengths of up to 15 feet for robotic applications.

TORCH MAINTENANCE MODULE

The Torch Maintenance Module (TMM) is a smart add-on designed for the Tregaskiss® ATLAS™ Robotic ThruArm MIG Welding Torch that enhances robotic welding operations by proactively monitoring cable performance and providing maintenance alerts before issues arise. By tracking key performance indicators and notifying users when the torch cable nears its maintenance threshold, the TMM enables planned downtime instead of reactive repairs, reducing unexpected interruptions, extending cable life, and ensuring consistent weld quality. Designed to bring greater predictability and efficiency to welding systems, the TMM helps optimize uptime and supports smarter maintenance planning. **Ordered Separately*



TORCH CONFIGURATIONS

STANDARD CONFIGURATIONS - 22 DEGREE NECKS

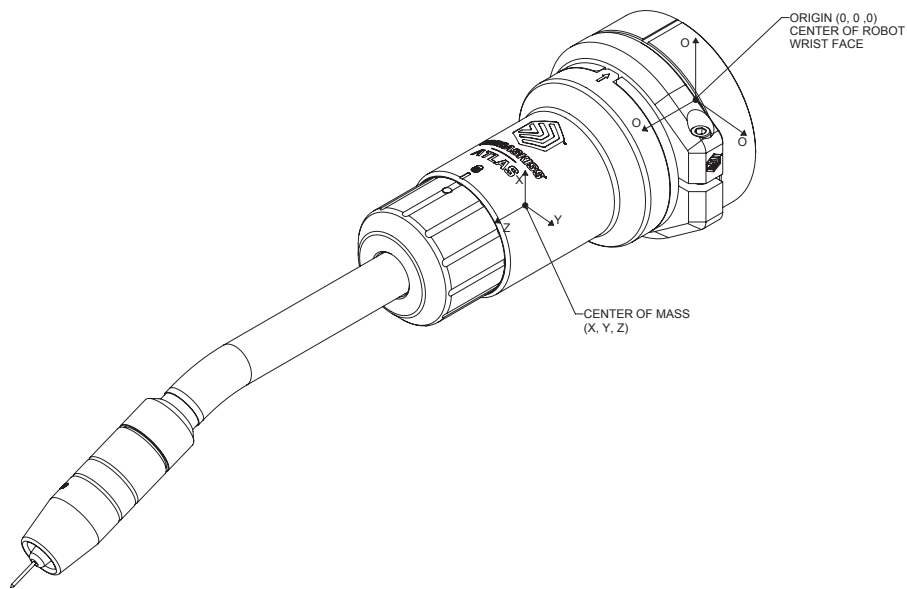
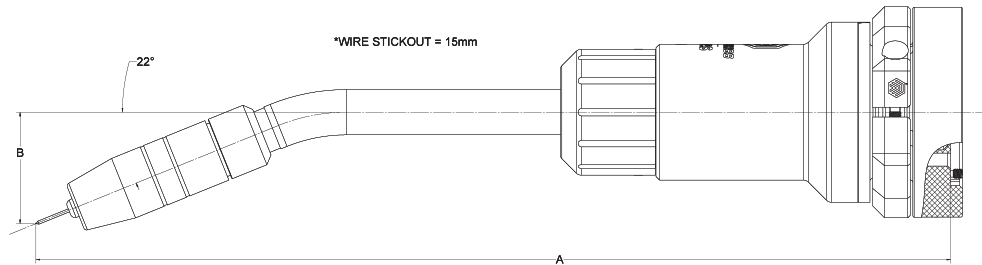

SOLID MOUNT — 22 DEGREE

| NECK | A (mm) | B (mm) | X (mm) | Y (mm) | Z (mm) | WEIGHT (kg) |
|--------------|-----------|-----------|-----------|-----------|-----------|----------------|
| GA248-047-22 | 386 | 47 | -2.69 | 0.08 | 122.41 | 1.99 |
| GA277-047-22 | 415 | 47 | -2.62 | 0.08 | 129.73 | 2.04 |
| GA323-047-22 | 461 | 47 | -2.53 | 0.07 | 142.01 | 2.12 |
| GA436-047-22 | 574 | 47 | -2.32 | 0.07 | 175.20 | 2.30 |

TORCH CONFIGURATIONS [CONTINUED]

STANDARD CONFIGURATIONS - 45 DEGREE NECKS

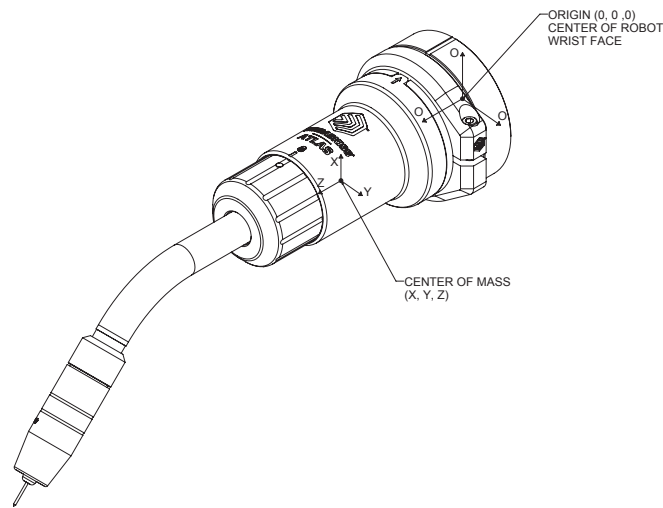
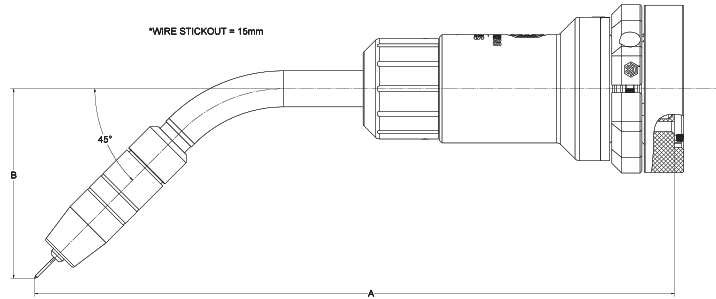

| SOLID MOUNT — 45 DEGREE | | | | | | |
|-------------------------|--------|--------|--------|--------|---------|-------------|
| NECK | A (mm) | B (mm) | X (mm) | Y (mm) | Z (mm) | WEIGHT (kg) |
| GA200-100-45 | 338 | 100 | -6.70 | 0.08 | 115.53 | 1.97 |
| GA229-100-45 | 367 | 100 | -6.54 | 0.08 | 122.66 | 2.02 |
| GA247-120-45 | 385 | 120 | -9.29 | 0.08 | 128.29 | 2.06 |
| GA267-100-45 | 405 | 100 | -6.34 | 0.08 | 132.51 | 2.08 |
| GA275-100-45 | 413 | 100 | -6.30 | 0.07 | 134.6 6 | 2.09 |
| GA302-120-45 | 440 | 120 | -8.90 | 0.07 | 143.31 | 2.15 |
| GA322-120-45 | 460 | 120 | -8.77 | -0.07 | 149.03 | 2.19 |
| GA378-120-45 | 516 | 120 | -8.41 | 0.07 | 165.71 | 2.28 |

ROBOT MAKE AND MODEL OPTIONS

ABB®

IRB1600ID, IRB1520ID
 IRB2600ID 15/1.85
 IRB2600ID 8/2.00
 IRB1660ID

FANUC®

100iC, 100iC-12L, M10iA-12
 120iC
 100iC-6L, 100iC-7L, M10iA-6L, M10iA-7L
 120iC-10L, 120iC-12L
 100iC-8L
 100iD, 100iD-12
 100iD-8L
 100iD-10L
 120iD
 120iD-12L

KAWASAKI®

BA006N
 BA006L
 BA013N
 BA013L

KUKA®

KR 5 HW
 KR 16 L8 HW
 KR 16 HW
 KR6 R1820HW
 KR8 R1420HW, KR8 R1620HW
 KR8 R2100HW

OTC DAIHEN®, NACHI®

OTC AX-V4
 OTC AX-V4L
 OTC AII-B4
 OTC AII-B4L
 OTC FD B4, Nachi NB04
 OTC FD B4L, Nachi NB04L
 OTC FD B6, Nachi NB6
 OTC FD B6L, Nachi NB6L

PANASONIC®

TB1800WGIII
 TM-1100, TM-1400
 TM-1800
 TM-1600
 TM-2000

YASKAWA® MOTOMAN®

MA3100
 MA1440, AR1440, MH12
 MA2010, AR2010
 MA3120, AR3120
 MH24, AR1730

CONSUMABLE OPTIONS

ACCULOCK™ HEAVY DUTY (HD) COPPER CONTACT TIPS

| | | | |
|-----------|-----------------------------------|----------|-----------------------------------|
| T-A030CH* | for 0.030" (0.8 mm) wire; qty. 10 | T-A062CH | for 1/16" (1.6 mm) wire; qty. 10 |
| T-A035CH* | for 0.035" (0.9 mm) wire; qty. 10 | T-A072CH | for 0.072" (1.8 mm) wire; qty. 10 |
| T-A039CH* | for 0.039" (1.0 mm) wire; qty. 10 | T-A078CH | for 5/64" (2.0 mm) wire; qty. 10 |
| T-A045CH* | for 0.045" (1.2 mm) wire; qty. 10 | T-A094CH | for 3/32" (2.4 mm) wire; qty. 10 |
| T-A052CH* | for 0.052" (1.3 mm) wire; qty. 10 | | |

NOTE: ADD "-100" TO END OF THE ABOVE HD COPPER CONTACT TIP PART NUMBERS FOR QUANTITIES OF 100.

*ADD "-1000" TO END OF THE ABOVE PART NUMBERS FOR QUANTITIES OF 1000.

ACCULOCK™ HEAVY DUTY (HD) CHROME ZIRCONIUM CONTACT TIPS

| | | | |
|----------|-----------------------------------|----------|-----------------------------------|
| T-A030ZH | for 0.030" (0.8 mm) wire; qty. 10 | T-A039ZH | for 0.039" (1.0 mm) wire; qty. 10 |
| T-A035ZH | for 0.035" (0.9 mm) wire; qty. 10 | T-A045ZH | for 0.045" (1.2 mm) wire; qty. 10 |

NOTE: ADD "-100" TO THE END OF THE ABOVE HD CHROME ZIRCONIUM CONTACT TIP PART NUMBERS FOR QUANTITIES OF 100.

ACCULOCK™ HDP CONTACT TIPS

| | | | |
|----------|-----------------------------------|----------|-----------------------------------|
| T-A035WH | for 0.035" (0.9 mm) wire; qty. 10 | T-A045WH | for 0.045" (1.2 mm) wire; qty. 10 |
| T-A039WH | for 0.039" (1.0 mm) wire; qty. 10 | T-A052WH | for 0.052" (1.3 mm) wire; qty. 10 |

NOTE: ADD "-100" TO THE END OF THE ABOVE HDP CONTACT TIP PART NUMBERS FOR QUANTITIES OF 100.

CONSUMABLE OPTIONS [CONTINUED]

ACCULOCK™ TEACH POINTERS [USED FOR ROBOTIC PROGRAMMING]

| | | | |
|----------|--------------------------|----------|---------------------------|
| T-A001TP | Adjustable teach pointer | T-A075TP | Teach pointer, 3/4" CTWD |
| T-A050TP | Teach pointer, 1/2" CTWD | T-A10MTP | Teach pointer, 10 mm CTWD |
| T-A062TP | Teach pointer, 5/8" CTWD | T-A15MTP | Teach pointer, 15 mm CTWD |

ACCULOCK™ R GAS DIFFUSERS

| | | | |
|--------|-------------------------------------|--------|-----------------------------------|
| D-ATTH | Gas diffuser, thread-on, AccuLock R | D-ATSH | Gas diffuser, slip-on, AccuLock R |
|--------|-------------------------------------|--------|-----------------------------------|

NOTE: ADD "-100" TO THE END OF THE ABOVE GAS DIFFUSER PART NUMBERS FOR QUANTITIES OF 100.

TOUGH LOCK® HEAVY DUTY [HD] CONTACT TIPS

| | | | |
|------------|--------------------------|------------|--------------------------|
| 403-20-30 | for 0.030" (0.8 mm) wire | 403-20-1.4 | for 0.055" (1.4 mm) wire |
| 403-20-35 | for 0.035" (0.9 mm) wire | 403-20-116 | for 1/16" (1.6 mm) wire |
| 403-20-1.0 | for 0.040" (1.0 mm) wire | 403-20-1.8 | for 0.072" (1.8 mm) wire |
| 403-20-45 | for 0.045" (1.2 mm) wire | 403-20-78 | for 0.078" (2.0 mm) wire |
| 403-20-364 | for 3/64" (1.2 mm) wire | 403-20-564 | for 5/64" (2.0 mm) wire |
| 403-20-52 | for 0.052" (1.3 mm) wire | 403-20-332 | for 3/32" (2.4 mm) wire |

TOUGH LOCK® HEAVY DUTY TAPERED CONTACT TIPS

| | | | |
|------------|--------------------------|------------|--------------------------|
| 403-21-30 | for 0.030" (0.8 mm) wire | 403-21-45 | for 0.045" (1.2 mm) wire |
| 403-21-35 | for 0.035" (0.9 mm) wire | 403-21-52 | for 0.052" (1.3 mm) wire |
| 403-21-1.0 | for 0.040" (1.0 mm) wire | 403-21-116 | for 1/16" (1.6 mm) wire |

TOUGH LOCK® EXTENDED LIFE HEAVY DUTY [EHD] CONTACT TIPS

| | | | |
|------------|--------------------------|------------|--------------------------|
| 403-27-30 | for 0.030" (0.8 mm) wire | 403-27-45 | for 0.045" (1.2 mm) wire |
| 403-27-35 | for 0.035" (0.9 mm) wire | 403-27-364 | for 3/64" (1.2 mm) wire |
| 403-27-1.0 | for 0.040" (1.0 mm) wire | | |

TOUGH LOCK® STANDARD DUTY [SD] CONTACT TIPS

| | | | |
|-----------|--------------------------|-----------|--------------------------|
| 403-14-30 | for 0.030" (0.8 mm) wire | 403-14-45 | for 0.045" (1.2 mm) wire |
| 403-14-35 | for 0.035" (0.9 mm) wire | | |

TOUGH LOCK® STANDARD DUTY TAPERED CONTACT TIPS

| | | | |
|-----------|--------------------------|-----------|--------------------------|
| 403-12-30 | for 0.030" (0.8 mm) wire | | |
| 403-12-35 | for 0.035" (0.9 mm) wire | 403-12-45 | for 0.045" (1.2 mm) wire |

TOUGH LOCK® TEACH POINTERS [USED FOR ROBOTIC PROGRAMMING]

| | | | |
|------------|----------------------|-------------|----------------------|
| 403-20-01 | Adjustable teach tip | 403-20-075 | Teach tip 3/4" CTWD |
| 403-20-05 | Teach tip 1/2" CTWD | 403-20-10mm | Teach tip 10 mm CTWD |
| 403-20-062 | Teach tip 5/8" CTWD | 403-20-15mm | Teach tip 15 mm CTWD |

TOUGH LOCK® RETAINING HEADS

| | | | |
|--------|---|--------|---|
| 404-18 | SD – retaining head for slip-on nozzles | 404-32 | HD – retaining head for slip-on nozzles |
| | | 404-52 | HD – retaining head for thread-on nozzles |

CONSUMABLE OPTIONS [CONTINUED]

NOZZLES

| Part Number | Description | Style | COMPATIBLE CONSUMABLES SERIES | |
|-------------|---|-----------|-------------------------------|------------|
| | | | TOUGH LOCK | AccuLock R |
| 401-6-62 | HD - 5/8" bore, 1/8" recess (copper) | Slip-on | X | X |
| 401-81-62 | HD - 5/8" bore, 1/8" stick out (copper) | Slip-on | X | X |
| 401-4-62 | SD - 5/8" bore, 1/8" recess (copper) | Slip-on | X | X |
| 401-8-62 | SD - 5/8" bore, 1/8" stick out (copper) | Slip-on | X | X |
| 401-42-50 | SD - 1/2" bore, 1/8" recess (bottleneck, brass) | Slip-on | X | |
| 401-48-50 | SD - 1/2" bore, 1/8" stick out (bottleneck, brass) | Slip-on | X | |
| 401-48-62 | HD - 5/8" bore, flush tip (bottleneck, copper) | Slip-on | X | X |
| 401-44-50 | SD - 1/2" bore, 1/4" stick out (bottleneck, brass) | Slip-on | X | |
| 401-49-50 | HD - 1/2" bore, flush tip (bottleneck, brass) | Slip-on | X | |
| 401-71-62 | HD - 5/8" bore, 1/8" recess (brass), straight bore | Slip-on | | X |
| 401-87-62 | HD - 5/8" bore, 1/8" stick out (brass) | Slip-on | X | X |
| 401-14-62 | HD - 5/8" bore, 1/8" recess (copper) | Thread-on | X | X |
| 401-41-62 | HD - 5/8" bore, 1/8" stick out (brass) | Thread-on | X | |
| 401-53-62 | HD - 5/8" bore, 1/8" stick out (bottleneck, copper) | Thread-on | X | |
| 401-20-62 | HD - 5/8" bore, 1/8" stick out (copper) | Thread-on | X | X |
| 401-43-62 | SD - 5/8" bore, 1/8" recess (copper) | Thread-on | X | X |
| 401-18-62 | SD - 5/8" bore, 1/8" stick out (copper) | Thread-on | X | X |
| 401-30-62 | SD - 5/8" bore, 1/8" stick out (bottleneck, brass) | Slip-on | X | X |
| 401-30-62T | SD - 5/8" bore, 1/8" stick out (bottleneck, brass) | Thread-on | X | X |

SEE THE TOUGH LOCK CONSUMABLES SPEC SHEET (SP-TLC) FOR MORE OPTIONS

QUICK LOAD® LINERS

| | |
|-------------|---|
| 415-26 | QUICK LOAD Liner Retainer |
| 415-24 | QUICK LOAD Liner Retainer (required for 3/32" wire) |
| 415-35-6Q | QUICK LOAD Liner for 0.035" (0.9 mm) - 0.045" (1.2 mm) wire; 6' (1.8 m) |
| 415-35-10Q | QUICK LOAD Liner for 0.035" (0.9 mm) - 0.045" (1.2 mm) wire; 10' (3.05 m) |
| 415-35-15Q | QUICK LOAD Liner for 0.035" (0.9 mm) - 0.045" (1.2 mm) wire; 15' (4.5 m) |
| 415-116-6Q | QUICK LOAD Liner for 0.045" (1.2 mm) - 1/16" (1.6 mm) wire; 6' (1.8 m) |
| 415-116-10Q | QUICK LOAD Liner for 0.045" (1.2 mm) - 1/16" (1.6 mm) wire; 10' (3.05 m) |
| 415-116-15Q | QUICK LOAD Liner for 0.045" (1.2 mm) - 1/16" (1.6 mm) wire; 15' (4.5 m) |

QUICK LOAD® E-Z FEED™ LINERS *STANDARD ON ATLAS

| | |
|--------------|--|
| 415-26 | QUICK LOAD Liner Retainer (required for both the 415-35-062Q and 415-35-152Q liners) |
| 415-31 | QUICK LOAD Liner Retainer (required for both 415-116-062Q and 415-116-152Q liners) |
| 415-35-152Q | QUICK LOAD Liner for 0.035" (0.9 mm) - 0.045" (1.2 mm) cored wire; 15' (4.57 m) (requires 415-26 retainer) |
| 415-116-062Q | QUICK LOAD Liner for 0.045" (1.2 mm) - 1/16" (1.6 mm) cored wire; 6' (1.8 m) (requires 415-31 retainer) |

REAR LOAD LINERS (required for MIG Torches equipped with wire brake only)

| | |
|------------|--|
| 415-30-6 | for 0.030" (0.8 mm) wire; 6' (1.8 m) – round wound |
| 415-30-15 | for 0.030" (0.8 mm) wire; 15' (4.5 m) – round wound |
| 415-35-6 | for 0.035" (0.9 mm) - 0.045" (1.2 mm) wire; 6' (1.8 m) – round wound |
| 415-35-10 | for 0.035" (0.9 mm) - 0.045" (1.2 mm) wire; 10' (3.05 m) – round wound |
| 415-35-15 | for 0.035" (0.9 mm) - 0.045" (1.2 mm) wire; 15' (4.5 m) – round wound |
| 415-116-6 | for 0.045" (1.2 mm) - 1/16" (1.6 mm) wire; 6' (1.8 m) – round wound |
| 415-116-10 | for 0.045" (1.2 mm) - 1/16" (1.6 mm) wire; 10' (3.05 m) – round wound |
| 415-116-15 | for 0.045" (1.2 mm) - 1/16" (1.6 mm) wire; 15' (4.5 m) – round wound |
| 415-564-6 | for 1/16" (1.6 mm) - 5/64" (2.0 mm) wire; 6' (1.8 m) – round wound |
| 415-564-15 | for 1/16" (1.6 mm) - 5/64" (2.0 mm) wire; 15' (4.5 m) – flat wound |
| 415-332-15 | for 0.078" (2.0 mm) - 3/32" (2.4 mm) wire; 15' (4.5 m) – flat wound |

COMPONENTS

AIR COOLED NECKS

| | | |
|---------------------|------------------------------|-----------------------------------|
| GA200-100-45 | 200 mm x 100 mm Offset - 45° | <i>See Page 5 for Overall TCP</i> |
| GA229-100-45 | 229 mm x 100 mm Offset - 45° | <i>See Page 5 for Overall TCP</i> |
| GA247-120-45 | 247 mm x 120 mm Offset - 45° | <i>See Page 5 for Overall TCP</i> |
| GA267-100-45 | 267 mm x 100 mm Offset - 45° | <i>See Page 5 for Overall TCP</i> |
| GA275-100-45 | 275 mm x 100 mm Offset - 45° | <i>See Page 5 for Overall TCP</i> |
| GA302-120-45 | 302 mm x 120 mm Offset - 45° | <i>See Page 5 for Overall TCP</i> |
| GA322-120-45 | 322 mm x 120 mm Offset - 45° | <i>See Page 5 for Overall TCP</i> |
| GA378-120-45 | 378 mm x 120 mm Offset - 45° | <i>See Page 4 for Overall TCP</i> |
| GA248-047-22 | 248 mm x 47 mm Offset - 22° | <i>See Page 4 for Overall TCP</i> |
| GA277-047-22 | 277 mm x 47 mm Offset - 22° | <i>See Page 4 for Overall TCP</i> |
| GA323-047-22 | 323 mm x 47 mm Offset - 22° | <i>See Page 4 for Overall TCP</i> |
| GA436-047-22 | 436 mm x 47 mm Offset - 22° | <i>See Page 4 for Overall TCP</i> |

LSR+ [LOW-STRESS ROBOTIC] UNICABLES

| ATLAS LSR Part Number | Configurator Digit | Robot Make | Robot Model | Feeder Main | Feeder Extended Description | Feeder Placement |
|-----------------------|--------------------|-------------|------------------------|-----------------------|--|------------------|
| UA-0810 | 0810 | Fanuc | 100iC, 100iC-12L | All | OTC, Lincoln, Miller, Panasonic, Tweco Style | |
| UA-0810 | 0810 | Panasonic | TM-1100 / 1400 | Panasonic | | |
| UA-0850 | 0850 | Fanuc | 100iD | Miller Auto Continuum | | |
| UA-0850 | 0850 | Panasonic | TM-1100 / 1400 | Miller Auto Axxess | | |
| UA-0880 | 0880 | Fanuc | 100iD | Lincoln | | |
| UA-0880 | 0880 | Fanuc | 100iC, 100iC-12L | Fronius VR-1500 PAP | | |
| UA-0880 | 0880 | OTC / NACHI | FD B4 / NB04 | All | OTC, Lincoln, Miller, Panasonic, Tweco Style | |
| UA-0880 | 0880 | OTC / NACHI | FD-B6/ NB6 | OTC | | |
| UA-0910 | 0910 | Panasonic | TM-1100 / 1400 | Miller Auto Continuum | | |
| UA-0910 | 0910 | KUKA | KR5 HW | 100iC , M10iA | OTC, Lincoln, Miller, Panasonic, Tweco Style | |
| UA-0910 | 0910 | Motoman | AR1440 , MA1440 , MH12 | All | OTC, Lincoln, Miller, Panasonic, Tweco Style | |

LSR+ [LOW-STRESS ROBOTIC] UNICABLES

[CONTINUED]

| ATLAS LSR Part Number | Configurator Digit/Unicable Length (mm) | Robot Make | Robot Model | Feeder Main | Feeder Extended Description | Feeder Placement |
|-----------------------|---|------------|---|-----------------------|--|------------------|
| UA-0920 | 0920 | Motoman | EA1400N | Fronius VR-1500PAP | OTC, Lincoln, Miller, Panasonic, Tweco Style | |
| UA-0920 | 0920 | Motoman | EA1400N / SSA2000 | All | | |
| UA-0960 | 0960 | KUKA | KR8 R1420HW/ R1620HW | Miller Auto Continuum | | |
| UA-0960 | 0960 | Fanuc | 100iD, M10iD-12 | Fronius WF25iR PAP | | |
| UA-0960 | 0960 | KUKA | KR8 R1420HW/ R1620HW | Lincoln | | |
| UA-0980 | 0980 | Motoman | AR1440, MA1440 | Fronius VR-1500PAP | | |
| UA-0980 | 0980 | Fanuc | 120iC | All | OTC, Lincoln, Miller, Panasonic, Tweco Style | |
| UA-0980 | 0980 | ABB | IRB1660ID | Fronius VR-1500PAP | | |
| UA-0980 | 0980 | KUKA | KR16 HW | All | OTC, Lincoln, Miller, Panasonic, Tweco Style | |
| UA-1020 | 1020 | ABB | IRB1600ID | Fronius VR-1500PAP | | |
| UA-1020 | 1020 | Fanuc | 100iC-6L, 100iC-7L, MA10iA-6L, MA10iA-7L | All | OTC, Lincoln, Miller, Panasonic, Tweco Style | |
| UA-1030 | 1030 | OTC/NACHI | AX-V4 | All | OTC, Lincoln, Miller, Panasonic, Tweco Style | |
| UA-1030 | 1030 | Fanuc | 120iD | Miller Auto Continuum | | |
| UA-1050 | 1050 | ABB | IRB1660iD | Miller Auto Continuum | | |
| UA-1050 | 1050 | Fanuc | 100iD-10L | Miller Auto Continuum | | |
| UA-1050 | 1050 | Kawasaki | BA006N | All | OTC, Lincoln, Miller, Panasonic, Tweco Style | |
| UA-1050 | 1050 | Panasonic | TM-1800 | Panasonic | OTC, Lincoln, Miller, Panasonic, Tweco Style | |
| UA-1050 | 1050 | Panasonic | TM-1600 | Panasonic | | |
| UA-1050 | 1050 | Kawasaki | BA013N | All | OTC, Lincoln, Miller, Panasonic, Tweco Style | |
| UA-1060 | 1060 | Fanuc | 120iC | | | |
| UA-1060 | 1060 | Motoman | AR1730, MH24 | All | | |
| UA-1060 | 1060 | Panasonic | TM-1600 | Miller Auto Axxess | | |
| UA-1080 | 1080 | Fanuc | 100iD-10L | Lincoln | | |
| UA-1080 | 1080 | Fanuc | 120iD | Lincoln | | |
| UA-1100 | 1100 | Panasonic | TM-1800 | Miller Auto Axxess | | |
| UA-1100 | 1100 | Fanuc | Fanuc, 100iC-6L, 100iC-7L, MA10iA-6L, MA10iA-7L | | | |

LSR+ [LOW-STRESS ROBOTIC] UNICABLES

[CONTINUED]

| ATLAS LSR Part Number | Configurator Digit/Unicable Length (mm) | Robot Make | Robot Model | Feeder Main | Feeder Extended Description | Feeder Placement |
|-----------------------|---|------------|-------------------------------------|-----------------------|--|------------------|
| UA-1100 | 1100 | ABB | IRB 1660iD | All | OTC, Lincoln, Miller, Panasonic, Tweco Style | |
| UA-1120 | 1120 | Panasonic | TM-1600 | Panasonic | | |
| UA-1120 | 1120 | Panasonic | TM-1600 | Miller Auto Continuum | | |
| UA-1120 | 1120 | KUKA | KR6 R1820HW | Miller Auto Continuum | | |
| UA-1120 | 1120 | Fanuc | 100iC-7L w/Fronius TPS 400i Feeder | Fronius VR-15000PAP | | |
| UA-1140 | 1140 | ABB | IRB 1600iD/1520iD | All | OTC, Lincoln, Miller, Panasonic, Tweco Style | |
| UA-1140 | 1140 | ABB | RB 1600iD / 1520iD / 2600iD 15/1.85 | Miller Auto Continuum | | |
| UA-1140 | 1140 | Panasonic | TM-1800 | Miller Auto Continuum | | |
| UA-1140 | 1140 | Motoman | MA1800 | All | OTC, Lincoln, Miller, Panasonic, Tweco Style | |
| UA-1170 | 1170 | Fanuc | 120iD | OTC | | |
| UA-1170 | 1170 | KUKA | KR6 R1820HW | Lincoln | | |
| UA-1170 | 1170 | Panasonic | TB1800WG3 | All | OTC, Lincoln, Miller, Panasonic, Tweco Style | |
| UA-1210 | 1210 | ABB | IRB 2600ID 15/1.85 | All | OTC, Lincoln, Miller, Panasonic, Tweco Style | |
| UA-1210 | 1210 | Fanuc | 120iC-10L, 120iC-12L | All | OTC, Lincoln, Miller, Panasonic, Tweco Style | |
| UA-1210 | 1210 | KUKA | KR8 R2100HW | Miller Auto Continuum | | |
| UA-1210 | 1210 | Motoman | EA1900N /MA1900 | Fronius | | |
| UA-1230 | 1230 | Fanuc | 100iC-8L, MA10iA-8L | All | OTC, Lincoln, Miller, Panasonic, Tweco Style | |
| UA-1240 | 1240 | Fanuc | 100iD-8L | Miller Auto Continuum | | |
| UA-1240 | 1240 | Comau | Smart5 Arc6 | All | OTC, Lincoln, Miller, Panasonic, Tweco Style | |
| UA-1240 | 1240 | Motoman | EA1900N /MA1900 | All | OTC, Lincoln, Miller, Panasonic, Tweco Style | |
| UA-1270 | 1270 | Panasonic | TM-2000 | Panasonic | | |
| UA-1270 | 1270 | Fanuc | 120iC-10L, 120iC-12L | Fronius VR-1500PAP | | |
| UA-1270 | 1270 | Fanuc | 100iD-8L | Lincoln | | |
| UA-1270 | 1270 | Fanuc | 100iD-8L | Lincoln | | |
| UA-1270 | 1270 | OTC/NACHI | FD-B6L/ NB6L | OTC | | |

| ATLAS LSR Part Number | Configurator Digit | Robot Make | Robot Model | Feeder Main | Feeder Extended Description | Feeder Placement |
|-----------------------|--------------------|------------|--|--------------------------|---|------------------|
| UA-1300 | 1300 | Panasonic | TM-2000 | Miller Auto Axxess | | |
| UA-1300 | 1300 | OTC/NACHI | FD B4L / NB04L | All | OTC, Lincoln, Miller, Panasonic, Tweco Style | |
| UA-1300 | 1300 | KUKA | KR8 R2100HW | Lincoln | | |
| UA-1330 | 1330 | Fanuc | 100iC-8L w/Fronius TPS 400i Feeder | | | |
| UA-1350 | 1350 | Panasonic | TM-2000 | | | |
| UA-1350 | 1350 | Fanuc | 100iC-8L, M10iA-8L | | | |
| UA-1350 | 1350 | OTC/NACHI | AX-V4L | | | |
| UA-1350 | 1350 | KUKA | KR16 L8 HW | All | OTC, Lincoln, Miller, Panasonic, Tweco Style | |
| UA-1380 | 1380 | Kawasaki | BA006L | All | OTC, Lincoln, Miller, Panasonic, Tweco Style | |
| UA-1400 | 1400 | Motoman | AR2010, MA2010 | All | OTC, Lincoln, Miller, Panasonic, Tweco Style | |
| UA-1410 | 1410 | Kawasaki | BA013L | All | OTC, Lincoln, Miller, Panasonic, Tweco Style | |
| UA-1410 | 1410 | ABB | IRB 2600iD 8/2.00 | All | OTC, Lincoln, Miller, Panasonic, Tweco Style | |
| UA-1460 | 1460 | Fanuc | 120iD-12L | Miller Auto Continuum | | |
| UA-1480 | 1480 | Motoman | AR2010, MA2010 | Fronius VR-15000PAP | | |
| UA-1500 | 1500 | Fanuc | 120iD-12L | Lincoln | | |
| UA-1580 | 1580 | Fanuc | 120iD-12L | OTC | | |
| UA-1860 | 1860 | Motoman | MA3100 / MA3120 | All | OTC, Lincoln, Miller, Panasonic, Tweco Style | |
| UA-2110 | 2110 | Fanuc | M710iC-12L | Miller Auto Continuum | | J3 Version |
| UA-2140 | 2140 | Fanuc | M710iC-12L | Miller Auto Axxess | | J3 |
| UA-2250 | 2250 | Fanuc | M710iC-12L | Lincoln | | J3 |
| UA-3120 | 3120 | Fanuc | 120iC w/Remote Mount Feeder | All-Remote Mount | | Remote |
| UA-3250 | 3250 | Fanuc | M710iC-12L | All-J2 | OTC, Lincoln, Miller, Panasonic, Tweco Style | J2 |

MOUNTING OPTIONS

SOLID MOUNT AND V-BAND CLAMP

| | |
|---------|----------------------------------|
| CHA-113 | Housing Solid Mount — All Models |
| VCA | V-Band Clamp |

INSULATING DISCS

| | | | |
|-----------|--------------------|-----------|---|
| AA-25-FID | Fanuc iD | AA-25-AB2 | ABB IRB 1660, 2600 |
| AA-25-FIC | Fanuc iC | AA-25-KU1 | Kuka KR5 HW, KR16 L8 |
| AA-25-MMA | Motoman MA/AR | AA-25-KU2 | Kuka KR16 HW |
| AA-25-PTM | Panasonic | AA-25-KU3 | Kuka KR8 R1420HW, KR6 |
| AA-25-K06 | Kawasaki BA006N/L | AA-25-DB6 | OTC / Daihen FDB6(L) |
| AA-25-K13 | Kawasaki BA013N/L | AA-25-DV4 | OTC / Daihen AX-V4(L) |
| AA-25-AB1 | ABB IRB 1520, 1600 | AA-20-DB4 | OTC / Daihen (FD)B4(L) (*Delrin Spacer) |
| | | AS-20-DB4 | OTC / Daihen (FD)B4(L) (*Aluminum Spacer) |

POWER PINS

POWER PINS

| | | | |
|--------|-----------|--------|--------------------------------|
| 214 | Tweco® #4 | 214-39 | OTC Daihen® |
| 214-1 | Miller® | 214-40 | Lincoln® |
| 214-12 | Tweco #5 | 214-41 | Fronius (North American Style) |
| 214-30 | Panasonic | | |

OPTIONAL ACCESSORIES SOLD SEPARATELY

| | | | |
|----------|---|-------|--------------------------------|
| UA-ABKIT | Air Blast | TMM-8 | Shielded M12 Cordset, 3m Long |
| TMM | Torch Maintenance Module | TMM-9 | Shielded M12 Cordset, 10m Long |
| TMM-C | Torch Maintenance Module with Shielded Cables | | |

KITS

| | | | |
|--------------|------------------|--------------|------------------------------|
| AA-M4KIT | Disc M5 Bolt Kit | CHA-ORINGKIT | Connector Housing O-ring Kit |
| AA-M6KIT | Disc M6 Bolt Kit | VCA-M5KIT | V-Band Bolt Kit |
| AA-M8KIT | Disc M8 Bolt Kit | GA-M5KIT | Gooseneck M5 Bolt Kit |
| CHA-LEVERKIT | Lever Kit | | |

PERIPHERALS & ACCESSORIES

TREGASKISS® TT4 REAMER

POWER THROUGH WELD SPATTER FOR INCREASED UPTIME AND WELD QUALITY



Automating spatter removal helps to extend the life of your robotic MIG torch and consumables, benefiting your bottom line, production uptime and throughput. Operates reliably in the harshest welding environments.

VISIT BERNARDTREGASKISS.COM/TT4 FOR ORDERING INFORMATION.

TOUGH GARD® MULTI-FEED SYSTEM



Eliminate the need to frequently refill sprayer reservoirs with the TOUGH GARD multi-feed system from Tregaskiss. Feed up to 10 reamer units from a single 5-gallon or 55-gallon drum of TOUGH GARD anti-spatter liquid.

- TG-103-05-2 for 5-Gallon pail (up to 2 nozzle cleaning stations)
- TG-103-05-10 for 5-Gallon pail (up to 10 nozzle cleaning stations)
- TG-103-55-10 for 55-Gallon drum (up to 10 nozzle cleaning stations)

TOUGH GARD® ANTI-SPATTER LIQUID



This ready-to-use water-soluble, non-toxic product creates a sacrificial surface that reduces spatter adhesion. This prolongs the life of your consumables and minimizes downtime due to nozzle cleaning which can help reduce your operating and maintenance costs.

- TG-101-05 5.28 U.S. Gallon / 20 L
- TG-101-55 55 U.S. Gallon / 208 L
- TG-101-01 1 U.S. Gallon / 3.78 L
- TG-101-32SP 32 fl. oz. / 946 mL (spray bottle)
- TG-101-14S 16.9 fl. oz. / 500 mL

TOUGH GARD® MULTI-FEED SYSTEM HOSE

SOLD SEPARATELY

- TG-103-100 100' multi-feed hose
- TG-103-200 200' multi-feed hose

NECK CHECKING FIXTURE

The ATLAS® neck checking fixture measures the alignment of your robotic MIG gun neck relative to the tool center point (TCP). Should the neck be out of tolerance due to impact or prolonged usage, this fixture can be used to realign the neck rather than having to replace it.

- G-ATLAS Neck checking fixture ATLAS® air-cooled neck assemblies

ORDERING INFORMATION

TREGASKISS® ATLAS™ THRUARM ROBOTIC MIG TORCH

| Class | Type | Torch Mount (Solid, Clutch, Wire Brake) | Robot Make/Model | Length (in mm) | Power Pin | Neck | Nozzle | Wire Size | AB/ICE/TMM |
|-------------|---------------|---|----------------------------|-------------------|-------------------|-----------------------------------|-----------------------------------|---|---------------------|
| T | A | S | | | | D | L | | Order Separately |
| Thru Arm | Air Cooled | S Solid Mount | A Fanuc iD | 0810 | D OTC Daihen | A 200 mm x 100 mm Offset, 45° | A 401-6-62 AccuLock Slip On | B 0.030" (0.8 mm) | UA-ABKIT |
| | | | B Fanuc iC | 0850 | E Euro* | | | C 0.035" (0.9 mm) | Air Blast |
| | | | C Motoman MA/AR | 0880 | F Fronius | B 229 mm x 100 mm Offset, 45° | B 401-81-62 AccuLock Slip On | D 0.040" (1.0 mm) ^{^^} | TMM |
| | | | D Panasonic TM | 0910 | (N. American Pin) | | | E 0.045" (1.2 mm) | Coming Soon |
| | | | E Kawasaki BA006N/L | 0920 | L Lincoln | C 247 mm x 120 mm Offset, 45° | C 401-8-62 AccuLock Slip On | F 3/64" (1.19 mm) ^{^^^} | TMM-C |
| | | | F Kawasaki BA013N/L | 0960 | M Miller | | | G 0.052" (1.32 mm) ^{^^} | Coming Soon |
| | | | G ABB IRB 1520, 1600 | 0980 | P Panasonic | D 267 mm x 100 mm Offset, 45° | D 401-30-62 AccuLock Slip On | H 1/16" (1.6 mm) ^{^^} | |
| | | | H ABB IRB 1660, 2600 | 1020 | T Tweco #4 | | | 0 No Consumables | |
| | | | J KUKA KR5 HW, KR16 L8 | 1030 | W Tweco #5 | E 275 mm x 100 mm Offset, 45° | E 401-14-62 AccuLock Thread On | | |
| | | | K KUKA KR16 HW | 1050 | | | | F 401-20-62 AccuLock Thread On | |
| | | | L KUKA KR8 R1420HW, KR6 | 1060 1080 | | F 302 mm x 120 mm Offset - 45° | | G 401-43-62 AccuLock Thread On | |
| | | | M OTC / Daihen FDB6(L) | 1100 | | G N/A | | H 401-30-62T AccuLock Thread On | |
| | | | N OTC / Daihen AX-V4(L) | 1120 | | H 322 mm x 120 mm Offset, 45° | | 0 No Consumables | |
| | | | P OTC / Daihen (FD)b4(L) | 1140 | | J N/A | | J 401-6-62 TOUGH LOCK HD Slip On | |
| | | | | 1170 | | K 378 mm x 120 mm Offset, 45° | | K 401-81-62 TOUGH LOCK HD Slip On | |
| | | | | 1210 | | | | L 401-8-62 TOUGH LOCK HD Slip On | |
| | | | | 1230 | | L N/A | | M 401-30-62 TOUGH LOCK HD Slip On | |
| | | | | 1240 | | M N/A | | N 401-14-62 TOUGH LOCK HD Thread On | |
| | | | | 1270 | | N 248 mm x 47 mm Offset, 22° | | P 401-20-62 TOUGH LOCK HD Thread On | |
| | | | | 1290 | | | | Q 401-43-62 TOUGH LOCK HD Thread On | |
| | | | | 1300 | | P 277 mm x 47 mm Offset, 22° | | R 401-30-62T TOUGH LOCK HD Thread On | |
| | | | | 1330 | | | | S 401-42-50 TOUGH LOCK HD Slip On [™] | |
| | | | | 1350 | | Q 323 mm x 47 mm Offset, 22° | | T 401-48-50 TOUGH LOCK HD Slip On [™] | |
| | | | | 1380 | | | | U 401-42-50 TOUGH LOCK SD Slip On ^{™^^} | |
| | | | | 1400 | | R 436 mm x 47 mm Offset, 22° | | V 401-48-50 TOUGH LOCK SD Slip On ^{™^^} | |
| | | | | 1410 | | | | W 401-48-62 AccuLock HD Slip On | |
| | | | | 1460 | | 0 No Neck | | Y 401-18-62 HDP .045" AccuLock | |
| | | | | 1480 | | | | | |
| | 1500 | | | | | | | | |
| | 1580 | | | | | | | | |
| | 1860 | | | | | | | | |
| | 2110 | | | | | | | | |
| | 2140 | | | | | | | | |
| | 2160 | | | | | | | | |
| | 2250 | | | | | | | | |
| | 3120 | | | | | | | | |
| | 3250 | | | | | | | | |

*** TOUGH LOCK ONLY

^ COPPER

^^ NOT AVAILABLE TOUGH LOCK SD

BRAND AND PRODUCT NAMES SHOWN ABOVE ARE TRADEMARKS OF THEIR RESPECTIVE OWNERS.
TREGASKISS®, TOUGH GUN®, TOUGH LOCK®, QUICK LOAD® AND ACCULOCK™ ARE TRADEMARKS OF TREGASKISS, A DIVISION OF ITW CANADA INC.
SUBJECT TO CHANGE – THE INFORMATION PRESENTED IN THIS SPEC SHEET IS ACCURATE TO THE BEST OF OUR KNOWLEDGE AT THE TIME OF PRINTING.
PLEASE VISIT BERNARDTREGASKISS.COM FOR THE MOST UP-TO-DATE INFORMATION.